

MUSD-02-B

Manual



MUSD Ebooklet



HARIO

MUGEN × SWITCH DRIPPER

Instruction Manual

Finished Capacity
200mL

Thank you for purchasing this HARIO product. Please be sure to read this instruction manual thoroughly in order to use this product correctly.

How to use

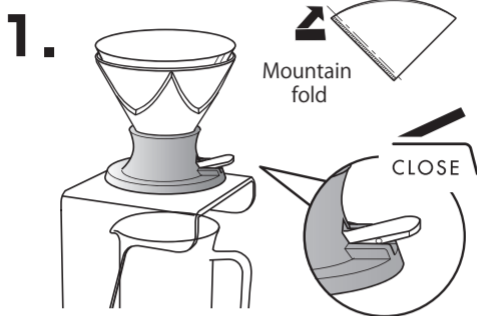

Place the dripper on a drip stand or a server. Then put a paper filter into the glass bowl.

- ※ Fold the paper filter at the perforated (dotted) line, open it and put it into the dripper.
- ※ Make sure the switch is in the position shown in the diagram to ensure the dripper is closed.



Put 20g of ground coffee (medium grind) into the dripper and pour in plenty of hot water (approx. 240mL).

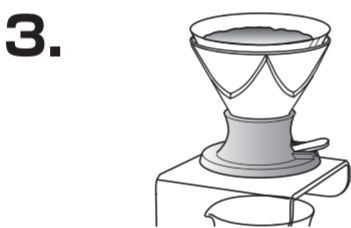

Let it steep for approximately 2 min. Stir as desired for a stronger brew.

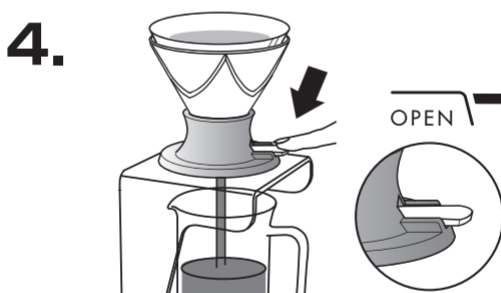

Press the switch to drip coffee.

- ※ Once you have pressed the switch, it will stay released even when you remove your finger.
- ※ Make sure to reset the switch before the next time you use the dripper.



Adjust the grind of the beans and the amount of time you steep them to find the perfect brew!

02

Please use HARIO V60 Paper filter 02.

Cone Shape
1-4 Cups

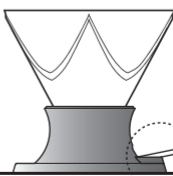

■ About the switch

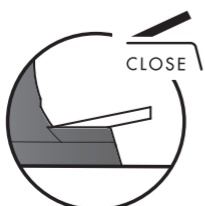

Make sure the switch is up to steep.

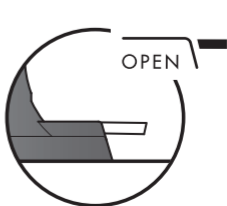

Coffee drips through when it is flush with the rim of the base.

Assembly instruction

Assemble and disassemble the glass bowl and base as shown in the diagram. Make sure to wear gloves.

Disassembly

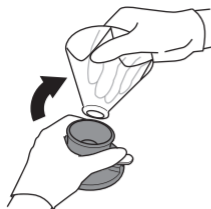

Assembly



[How to set the switch on the base]

- ① Stick the long narrow end into the hole of the base. Then insert it all the way in up to the base of the switch.
- ② Flip it over and set the switch onto the base as shown in the diagram. Confirm that the switch moves up and down before use.

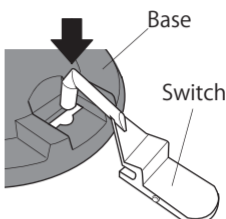

Ensure the switch is securely and correctly set to prevent deformation or damage. Please insert it firmly.

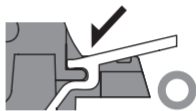
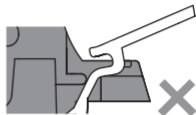

Handling precautions

⚠ Do not allow children to use this product. Do not use near children, and store out of reach of children.

- Do not touch or carry the dripper after putting in hot water as parts will be hot and may cause burns. Make sure to place it on a server or drip stand before pouring in hot water.



- Do not press the switch with force when placing the dripper on a server as this may cause the dripper to fall over and cause burns.



- Hot water will flow out of the bottom if the stainless steel ball is not in place. Please be careful not to lose it when washing.

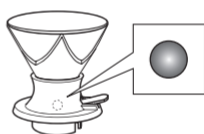

- Dripper body must be set correctly or it may leak. Make sure it is securely set before use.

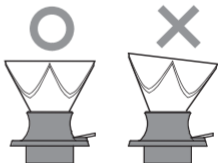

- Wash the product before using for the first time.
- If the product becomes damaged, please handle any broken pieces with care.
- Follow local rules on garbage disposal when disposing of this product.
- Do not store resin products near heat or open flame.
- Make sure the dripper and holder are securely in place before use.

Product Care

- Use a soft sponge and neutral detergent to clean this product.
- This product is dishwasher safe. Be sure to read the instruction manual provided with your dishwasher before use.
- Use diluted household bleach for deep cleaning. Make sure to follow all precautions indicated on the bleach and wash thoroughly with water when finished.

Material Guide

MADE IN JAPAN

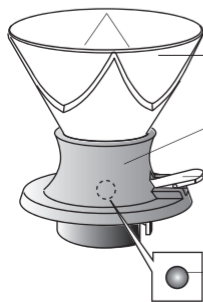

- Dripper body : AS resin
(heat resistant up to 90°C)
- Base : Silicone rubber
(Heat resistance temperature 180°C)
- Switch : PCT resin
(Heat resistance temperature 100°C)
- Stainless steel ball
: Stainless steel

All parts can be removed for cleaning. When re-assembling, be sure to read the Assembly instruction on the back thoroughly to ensure that all parts are set up properly.